

# DOHENY MEMORIAL LIBRARY

## Self-Guided Tour

BUILDING CODE **DML** [usc.edu/maps](http://usc.edu/maps)

**USC** Libraries

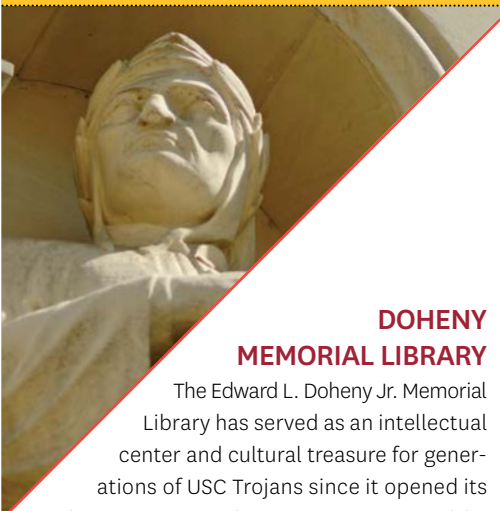

### DOHENY MEMORIAL LIBRARY

The Edward L. Doheny Jr. Memorial Library has served as an intellectual center and cultural treasure for generations of USC Trojans since it opened its doors on September 12, 1932. Designed by Boston architectural firm Cram and Ferguson, and built under the leadership of head librarian Charlotte Brown, the landmark building was USC's first freestanding library. Its synthesis of Gothic and Italian Romanesque architectural elements has earned many design awards, and its native California materials pay tribute to its regional heritage. The building is home to the university's special collections of rare books, manuscripts, and archival materials. In addition, it houses a general humanities collection, as well as the music, East Asian, and cinematic arts libraries. Decades after its doors opened, Doheny Memorial Library remains a wellspring for scholarship at the university—and one of its most enduring symbols.



# BASEMENT

In the spring of 2009, USC Libraries acquired a wide variety of primary and secondary materials for the study of the Holocaust, including rare books and pamphlets, monographs, diaries, photographs, and eyewitness accounts from Jewish survivors. It complements the USC Shoah Foundation's thousands of recorded testimonies and the Libraries' collections on exile studies.

The **HOLOCAUST AND GENOCIDE COLLECTION (1)** continues to grow with new material related to atrocities such as the Armenian, Bosnian, Cambodian, and Rwandan genocides. The diverse collection is a tremendous resource for USC researchers in fields such as history, political science, sociology, and visual studies. Access to the space is restricted to USC faculty, students, and staff. To obtain a key to the room, visit the circulation desk on the first floor.

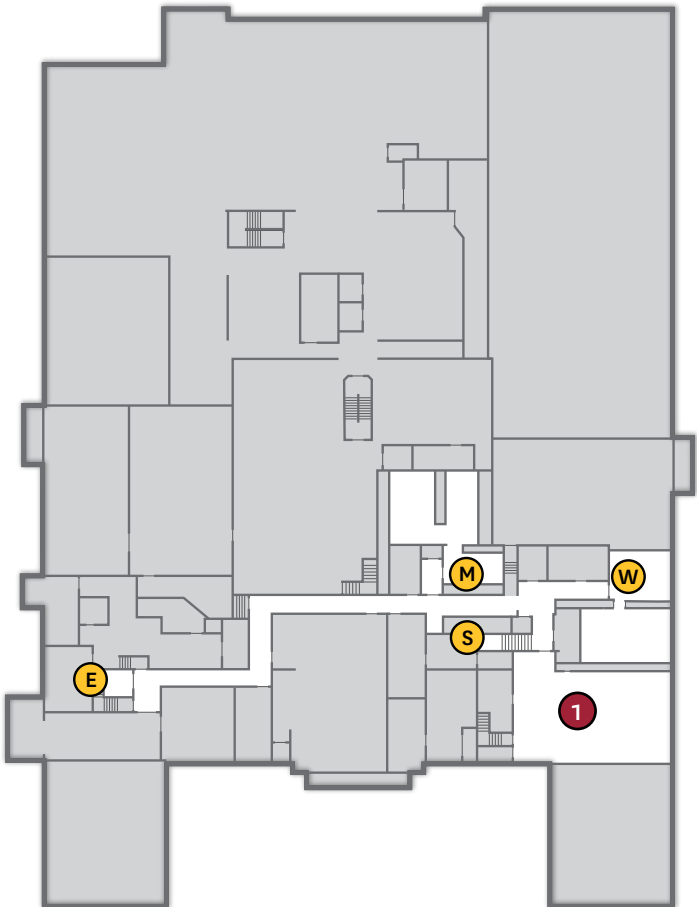

- W Women's Restroom
- M Men's Restroom
- S Stairway
- E Elevator

## GROUND FLOOR

Above the **EAST ENTRANCE (1)**, American sculptor Robert Merrell Gage's bas-relief *The Learners* is visible over the inscription, "Wise Men Lay Up Knowledge." **THE YOUNES AND SORAYA NAZARIAN PAVILION (2)** and **LITERATEA TEAHOUSE (3)** are ideal spots for study, lunch, and collaboration.

Inside the building, a hallway leads to the **MUSIC LIBRARY (4)**, where visitors can find scores, sound recordings, and books related to music history and theory. The ground-floor **ROTUNDA (5)** is an exhibition space, featuring items from USC's Special Collections throughout the academic year.

Past the rotunda on the left, the **CINEMATIC ARTS LIBRARY (6)** houses a collection of films, books, and materials related to television and motion picture history—as well as the archives of Hollywood studios, the Academy of Television Arts and Sciences, and hundreds of writers, actors, and directors.

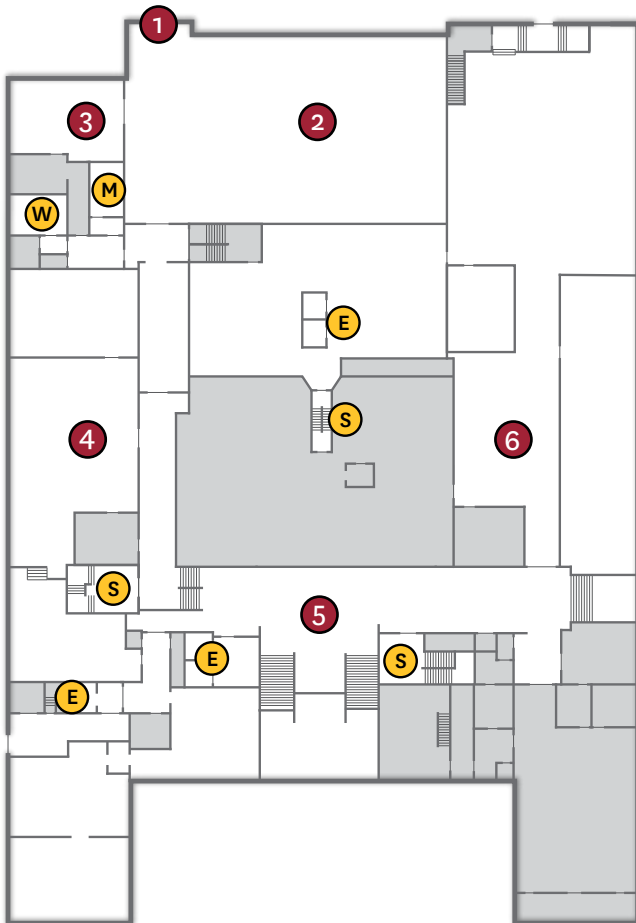

## FIRST FLOOR

Statues of William Shakespeare and Dante Alighieri frame the library's **MAIN ENTRANCE (1)**. Inside the cast-bronze doors, stairs lead up to the **ENTRANCE PAVILION (2)**, which features stained-glass windows designed by Boston artist Wilbur Herbert Burnham. Across from the stairs are Doheny's **CIRCULATION DESK** and **BOOKSTACKS ENTRANCE (3)**. The **TREASURE ROOM (4)** to the right of the entrance pavilion is an important exhibition space for the USC Libraries.

To the right of the Treasure Room is **FACULTY HALL (5)**, while the **LOS ANGELES TIMES REFERENCE ROOM (6)** opens to the left and is home to a reference desk as well as the annual USC Libraries Scriptor gala. The room's gold-and-blue coffered ceiling was designed by Italian émigré artist Giovanni Smeraldi.

To the left of the circulation desk is the Hall of Honor, home to the **TOP DRAWER SOCIETY (7)**, which celebrates library supporters and opens into the **EAST ASIAN LIBRARY (8)**. Our Chinese, Japanese, and Korean-language materials support the university's international focus and engagement with the Pacific Rim.

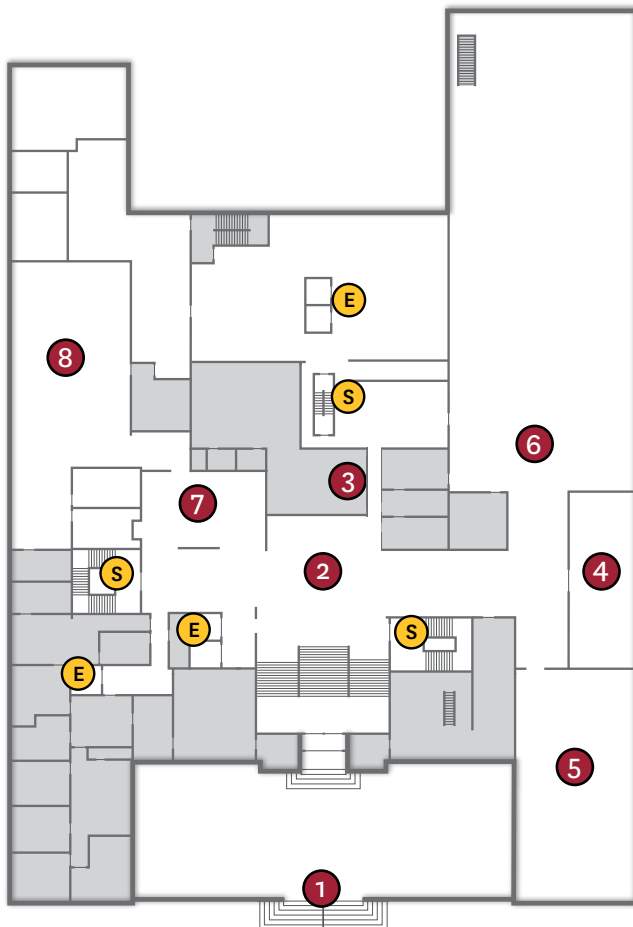

## SECOND FLOOR

The **USC SIDNEY HARMAN ACADEMY FOR POLYMATHIC STUDY (1)** offers a series of conversational encounters intended to encourage polymathic inquiry. For more information, visit [polymathic.usc.edu](http://polymathic.usc.edu). The **FRIENDS OF THE USC LIBRARIES LECTURE HALL (2)** hosts readings, lectures, and other public events throughout the year. The **INTELLECTUAL COMMONS (3)** is a popular study spot and is home to the reference collection of the Boeckmann Center for Iberian and Latin American Studies.

The **FEUCHTWANGER MEMORIAL LIBRARY (4)** is the gateway to USC's Special Collections, where rare books, manuscripts, and other unique items are housed. Across the hallway from Special Collections, the **HORTON RARE BOOK READING ROOM (5)** contains a selection of Lewis Carroll-related materials from the Cassady Collection. USC students and faculty, as well as researchers from around the world, use the room to consult rare materials from Special Collections.

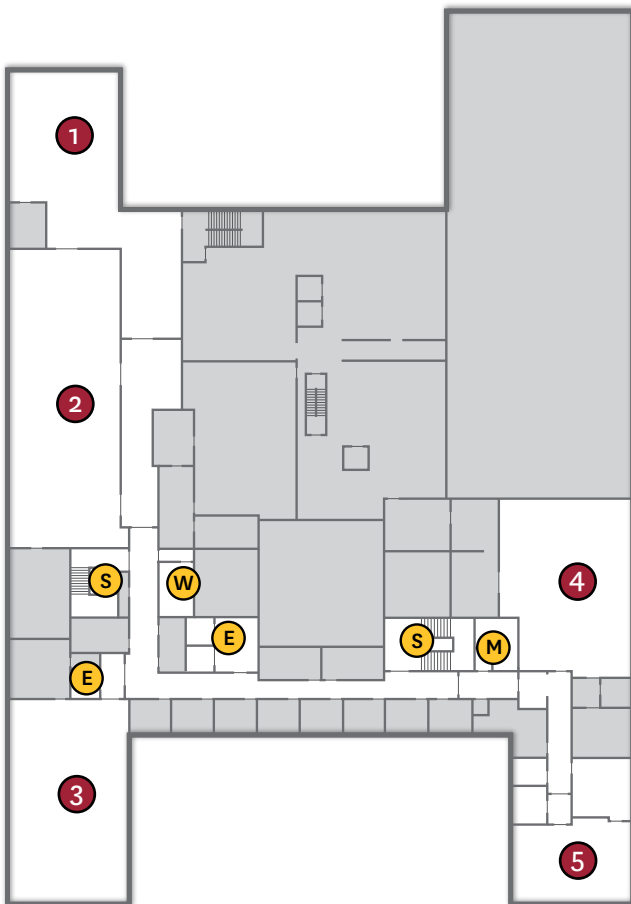

# QUICK REFERENCE

## CIRCULATION DESK

(213) 740-2924

## REFERENCE DESK

(213) 740-4039

## RESEARCH ASSISTANCE

[libraries.usc.edu/ask](http://libraries.usc.edu/ask)

## LIBRARY HOURS

[libraries.usc.edu/hours](http://libraries.usc.edu/hours)

## SOCIAL MEDIA

@USCLibraries | Twitter

@USCLibraries | Instagram

[facebook.com/USCLibraries](https://facebook.com/USCLibraries)

[youtube.com/usclibraries](https://youtube.com/usclibraries)



**FRONT UPPER LEFT** Statue of Italian poet Dante Alighieri from the front steps of the library **A** Detail of the coffered ceiling in the first-floor Times Reference Room **B** The first-floor Treasure Room hosts rotating exhibitions on a wide range of subject matters **C** Researchers examining materials in the second-floor Horton Rare Book Room **D** Guests at the annual Los Angeles Archives Bazaar in the first-floor Times Reference Room **E** Initiates of the Academy for Polymathic Study, housed on the second floor

**DOHENY MEMORIAL LIBRARY**  
3550 Trousdale Parkway  
University of Southern California  
Los Angeles, CA 90089-0182